

13 SPARE PARTS LIST 49.4211.02

49.4211.02	P350/16/0.80-1.10/3.8		P350.0003.02			23.02.00
Item-No.		in group	Pcs.	Description	Dimension	Field
A38.1230		P35.0104	1	SEALING SCREW		C13
A38.1230		P35.0106	1	SEALING SCREW		A3
A38.1265		P35.0103	5	SUSTAINING RING		B34+
[A38.1348]		P35.0105	1	ROTOR		--
[A38.1348]		P35.0107	1	ROTOR		--
A38.1351	*	P35.0105	8	VANE		A15+
A38.1351	*	P35.0107	8	VANE		B5
A38.1352		P35.0105	1	END PLATE		C14
A38.1352		P35.0107	1	END PLATE		B4
A38.1354		P35.0104	1	COVER		A16
A38.1354		P35.0106	1	COVER		C5
A38.1374		P35.0105	16	FELT		A14+
A38.1374		P35.0107	16	FELT		B5
A38.1376		A38.1348	1	ROTOR		B5
A38.1376		A38.1348	1	ROTOR		B5
A38.1377		A38.1348	1	COUPLING		B4
A38.1377		A38.1348	1	COUPLING		B4
A38.1378		A38.1348	1	DOWEL		B4
A38.1378		A38.1348	1	DOWEL		B4
A38.2307			1	INTERMEDIATE WHEEL	2-3	C2
A38.3405		P35.1401	2	RATCHET DISK		B38
A38.3407		P35.1401	1	THRUST WASHER		A38
A48.3138		P35.0109	1	PISTON ROD		B8
A48.3153		P35.0102	1	VALVE RING		B22
N11.1123			2	SCREW	M6 X 30	A34
N1.1106		P35.1401	3	SCREW	M6 X 20	B38
N1.1116			1	SCREW	M6 X 25	C4
N1.1144			1	SCREW	M6 X 70	A20
N1.1151			2	SCREW	M6 X 80	C15
N1.1152			2	SCREW	M6 X 60	D3
N1.1167			2	SCREW	M4 X 45	C2+
N1.1180		P35.0104	4	SCREW	M6 X 90	A16
N1.1180		P35.0106	4	SCREW	M6 X 90	B6+
N1.1195			5	SCREW	M8 X 1 X 36	C26+
N1.1805			2	SCREW	M5 X 8	D27
N1.1807			2	SCREW	M5 X 12	D27
N1.1818		P35.0109	1	SCREW	M5 X 20	B28
N1.1819			7	SCREW	M6 X 30	B1+
N1.1820		P35.0102	4	SCREW	M4 X 25	C24+
N1.1820		P35.0103	6	SCREW	M4 X 25	A33+
N1.2102			1	COUNTERSUNK SCREW	M6 X 20	B29
N1.2144			1	COUNTERSUNK SCREW	M6 X 30	C29
N1.3515		P35.0102	1	SOCKET SET SCREW	M4 X 8	D24
N1.5130		P35.1401	2	HEXAGON NUT	M10	A37
N1.5608		P35.0102	1	SLOTTED ROUND NUT	M8 X 1	A21
N1.5608		P35.0109	1	SLOTTED ROUND NUT	M8 X 1	B8
N1.6220			8	SPRING LOCK WASHER	M6	A20+
N1.6220		P35.0104	4	SPRING LOCK WASHER	M6	A15+
N1.6220		P35.0106	4	SPRING LOCK WASHER	M6	B6+
N1.6220		P35.1401	3	SPRING LOCK WASHER	M6	B38+
N1.6222			2	SPRING LOCK WASHER	M4	C2+

* = Wearing Parts

[] = Group

49.4211.02	P350/16/0.80-1.10/3.8		P350.0003.02			23.02.00
Item-No.		in group	Pcs.	Description	Dimension	Field
N1.6501			5	SAFETY WASHER	M8	C26+
N1.7302			2	SEALING SCREW	M10 X 1 X 8	C42+
N2.1107			1	SECURITY RING	E8	C29
N2.1118			1	SECURITY RING	E6	C29
N2.1212		P35.0109	1	SECURITY RING	J24	B10
N2.1220		P35.0109	1	SECURITY RING	JV47	C10
N2.1221		P35.0102	1	SECURITY RING	J36	A21
N2.1507		P35.0109	1	SPRING RING	22	C10
N2.1601		P35.0102	1	SPRING RING	SW12	C20
N2.1701		P35.0109	1	SECURITY RING	17	A8
N2.1803			2	SECURITY RING	4	B4
N2.1803		P35.0109	2	SECURITY RING	4	A8
N2.2101		P35.1255	1	PARALLEL PIN	5 m6 X 12	D3
N2.2105			1	PARALLEL PIN	6 m6 X 30	C29
N2.2106		P35.0109	1	PARALLEL PIN	5 m6 X 20	B28
N2.2109			3	PARALLEL PIN	8 m6 X 30	B26+
N2.2129			4	PARALLEL PIN	5 m6 X 10	C27+
N2.2138			1	PARALLEL PIN	4 m6 X 12	A29
N2.2172			1	PARALLEL PIN	5 m6 X 30	C4
N2.2174		P35.1209	2	PARALLEL PIN	6 m6 X 60	C2+
N2.2179			1	PARALLEL PIN	8 m6 X 45	D28
N2.2180		P35.0102	1	PARALLEL PIN	4 m6 X 16	B21
N2.2180		P35.1201	2	PARALLEL PIN	4 m6 X 16	B4
N2.2180		P35.1255	2	PARALLEL PIN	4 m6 X 16	D4
N2.2181		P35.0102	2	PARALLEL PIN	4 m6 X 8	C23
N2.2181		P35.0104	1	PARALLEL PIN	4 m6 X 8	D13
N2.2182			3	PARALLEL PIN	6 m6 X 16	D10+
N2.2413		P35.0105	1	DOWEL PIN	4 X 20	C14
N2.2413		P35.0107	1	DOWEL PIN	4 X 20	B4
N2.2445		P35.0105	1	DOWEL PIN	2.5 X 6	A14
N2.2445		P35.0107	1	DOWEL PIN	2.5 X 6	B5
N2.4204			1	RIVET	2 X 15	A29
N2.4205		P35.0109	3	RIVET	3 X 20	B8
N2.4407			4	RIVET	2 X 3	C2+
N2.4902			4	HAMMER HEAD BOLT	1.85 X 4.76	A40
N2.5179			1	PRESSURE SPRING	0.32 X 2.82 X 34/30.5	A29
N2.5182		P35.0103	2	PRESSURE SPRING	0.63 X 5.5 X 27/15.5	B32+
N2.5199		P35.0109	3	PRESSURE SPRING	0.6 X 4.6 X 40/23.5	B8
N2.5221			2	PRESSURE SPRING	1.5 X 14 X 17/4.5	A29
N2.5222		P35.0102	1	PRESSURE SPRING	1.1 X 21.5 X 80/7.5	A21
N2.5223		P35.0102	2	PRESSURE SPRING	0.8 X 8 X 31/11.5	C19+
N2.5224		P35.0104	2	PRESSURE SPRING	0.5 X 9 X 17/6.5	C17+
N2.5225		P35.0102	2	PRESSURE SPRING	0.3 X 6.3 X 26/19.5	B20+
N2.5226		P35.0103	2	PRESSURE SPRING	1 X 11 X 21.4/5.5	A34+
N2.5228		P35.0102	1	PRESSURE SPRING	0.90 X 6 X 47.50/24.5	C23
N2.5229		P35.0102	1	PRESSURE SPRING	1.1 X 14 X 65.4/10.5	A22
N2.5604		P35.1401	2	CUP SPRING	31.5 X 16.3 X 1.25	A38
N2.5609		P35.0104	2	CUP SPRING	45 X 22.4 X 1.75	B16
N2.5609		P35.0106	2	CUP SPRING	45 X 22.4 X 1.75	C5
N3.1123		P35.0105	1	BALL BEARING	10 X 26 X 8	C14
N3.1123		P35.0107	1	BALL BEARING	10 X 26 X 8	A5
N3.1133		P35.0105	1	BALL BEARING	10 X 30 X 14	B16
N3.1133		P35.0107	1	BALL BEARING	10 X 30 X 14	A5

* = Wearing Parts

[] = Group

49.4211.02	P350/16/0.80-1.10/3.8		P350.0003.02			23.02.00
Item-No.		in group	Pcs.	Description	Dimension	Field
N3.1134		P35.1209	1	BALL BEARING	7 X 22 X 7	C3
N3.1138		P35.0102	1	BALL BEARING	8 X 22 X 7	B20
N3.1138		P35.1201	1	BALL BEARING	8 X 22 X 7	B3
N3.1149		P35.0109	1	BALL BEARING	20 X 42 X 12	B9
N3.1150			2	BALL BEARING	70 X 90 X 10	C1+
N3.1702		P35.0102	5	BALL	4 MM	C22+
N3.1702		P35.0109	18	BALL	4 MM	B10
N3.1706		P35.0102	1	BALL	15 MM	B22
N3.2209		P35.0109	2	NEEDLE BEARING	16 X 24 X 13	B10
N3.2322		P35.1201	1	NEEDLE CASE	8 X 12 X 10	A3
N3.2322		P35.1209	1	NEEDLE CASE	8 X 12 X 10	C2
N3.2323		P35.1201	1	NEEDLE CASE	12 X 16 X 10	B4
N3.2323		P35.1209	1	NEEDLE CASE	12 X 16 X 10	C2
N3.2403		P35.0109	2	INNER RACEWAY	15 X 20 X 12	B2
N3.2403		P35.1201	1	INNER RACEWAY	15 X 20 X 12	B3
N3.2403		P35.1255	1	INNER RACEWAY	15 X 20 X 12	C3
N3.3149		P35.1221	2	SLIDE-BEARING	10 X 12 X 10	D3
N41.9128			1	ADHESIVE LABEL	30 X 10 X 0.1	B39
N41.9129			1	ADHESIVE LABEL	p max. 6 bar/87 psi	B39
N4.9158			1	LABEL	<<P350>>	B40
N4.9159			1	LABEL	<<CE>>	B39
N61.5606		P35.0102	1	REDUCING COUPLING		B21
[N6.3404]		P35.0102	1	PISTON	35 X 8	A21
[N6.3404]		P35.0109	1	PISTON	35 X 8	B8
N6.3504		N6.3404	1	INNER PACKING	8.3 X12.1X4	B8
N6.3504		N6.3404	1	INNER PACKING	8.3 X12.1X4	B8
N6.3508		N6.3404	1	EXTERNAL PACKING RING	35	B8
N6.3508		N6.3404	1	EXTERNAL PACKING RING	35	B8
N6.5509		P35.0104	1	EXHAUST SILENCER	28 X 20	C14
N6.5509		P35.0106	1	EXHAUST SILENCER	28 X 20	A3
N6.5510		P35.0104	1	EXHAUST SILENCER	18 X 20	C14
N6.5510		P35.0106	1	EXHAUST SILENCER	18 X 20	A3
N6.5624		P35.0102	1	ANGLE	G 1/4	A21
N6.6113		P35.0109	1	PACKING RING	10 X 16 X 4.5	A8
N6.6117		P35.0102	5	SEAL	6 X 13 X 2.3	B23+
N6.6121		P35.0102	1	SEAL	8 X 15 X 2.3	B24
N6.6121		P35.0103	5	SEAL	8 X 15 X 2.3	B34+
N6.6122		P35.0102	1	SEAL	20 X 13 X 2.3	C20
N6.6123		P35.0102	7	SEAL	12 X 19 X 2.3	B23+
N6.6147		P35.0102	1	SEAL	10 X 17 X 2.3	B22
N6.6155		P35.0109	1	SEAL	40 X 49 X 3	A10
N6.6156		P35.0109	1	SEAL	10 X 17	C12
N6.6157		P35.0104	2	PACKING RING	4 MM	C17+
N6.6159		P35.0109	3	PACKING RING	20 X 14 X 2.55	B11+
N6.6160		P35.0109	3	PACKING RING	2.5 X 1.6 X 56.6	B11+
N6.6161		P35.0102	1	PACKING RING	10 X 6 X 2.55	B20
N6.6162		P35.0109	3	PACKING RING	20 X 12 X 4.2	B11+
N6.6204		P35.0102	7	O-RING	18 X 2	B21+
N6.6209		P35.0103	6	O-RING	17 X 2	C34+
N6.6211			1	O-RING	16 X 2	A11
N6.6223		P35.0104	1	O-RING	50 X 2	C14
N6.6223		P35.0106	1	O-RING	50 X 2	A4
N6.6240			5	O-RING	15 X 3	B2+

* = Wearing Parts

[] = Group

49.4211.02	P350/16/0.80-1.10/3.8		P350.0003.02			23.02.00
Item-No.		in group	Pcs.	Description	Dimension	Field
N6.6240		P35.0106	1	O-RING	15 X 3	A3
N6.6241		P35.0105	2	O-RING	46 X 2	B14+
N6.6241		P35.0107	2	O-RING	46 X 2	A5+
N6.6247		P35.0102	1	O-RING	5 X 2.5	B21
N6.6253			1	O-RING	42 X 1,5	A9
N6.6255		P35.0102	11	O-RING	21 X 2	C19+
N6.6260			1	O-RING	73 X 2	A9
N6.6262		P35.0109	1	O-RING	32 X 2.0	A8
N6.6263		P35.0104	1	O-RING	15 X 2.5	C13
N6.6263		P35.0106	1	O-RING	15 X 2.5	A3
N6.6264			4	O-RING	4 X 2.0	C9+
N6.6265		P35.0106	1	O-RING	9 X 2.0	A3
N6.6266		P35.0102	1	O-RING	5 X 1.0	B19
N6.6266		P35.0104	2	O-RING	5 X 1.0	D17
N6.6267		P35.0102	3	O-RING	10 X 2.0	B21+
N6.6268		P35.0102	1	O-RING	6 X 2.5	B20
N6.6269		P35.0102	2	O-RING	8.5 X 2.0	B19+
N6.6269		P35.0104	4	O-RING	8.5 X 2.0	C16+
N6.6313		P35.0109	1	SEAL	55 X 44 X 4.2	A10
N6.6314		P35.0109	1	SEAL	70 X 59 X 4.2	B9
N6.6803		P35.0102	1	PACKING RING	10 X 19 X 7/ 9.8	A20
N6.6803		P35.1201	1	PACKING RING	10 X 19 X 7/ 9.8	A4
[P35.0102]			1	MOTOR FLANGE		A23
[P35.0103]			1	HANDLE		A36
[P35.0104]			1	WELDING MOTOR		A18
[P35.0105]		P35.0104	1	MOTOR CELL	EX. 2.5	A14
[P35.0106]			1	TENSIONING MOTOR		A4
[P35.0107]		P35.0106	1	MOTOR CELL	EX. 3,0	A6
[P35.0109]			1	BODY		A12
[P35.1101]		P35.0102	1	MOTOR FLANGE		B21
P35.1103			1	FIXING PLATE		B29
P35.1104	*		1	WELDING STOP GRIPPER		B28
P35.1106	*		1	GRIPPER		C28
P35.1107			1	GUIDE POLE		A29
P35.1108	*		1	GRIPPING JAW		B29
[P35.1109]			1	STOP BOLT		D27
P35.1111			1	BASE PLATE		C28
P35.1112			1	SEALING COVER		B11
P35.1113		P35.0109	1	PISTON GUIDE		B28
P35.1114		P35.0109	1	PISTON		A10
P35.1115	*	P35.0109	1	WELDING GRIPPER		C10
P35.1116		P35.0109	1	CENTERING BUSH		B9
P35.1117		P35.0109	1	WELDING EXCENTRIC		A9
P35.1118		P35.0109	1	HOLDER		C10
P35.1119		P35.0109	1	BALL CAGE		B10
P35.1123	*		1	CUTTER		B29
P35.1131			1	STRAP GUIDE		B29
P35.1136		P35.0102	1	PISTON		A21
[P35.1140]		P35.0104	1	MOTOR HOUSING		C15
P35.1146		P35.0105	1	JACKET		B14
P35.1147		P35.0105	1	END PLATE		A14
P35.1148		P35.0109	1	PISTON		B11
P35.1149		P35.0109	1	PISTON		C11

* = Wearing Parts

[] = Group

49.4211.02	P350/16/0.80-1.10/3.8		P350.0003.02		23.02.00	
Item-No.		in group	Pcs.	Description	Dimension	Field
P35.1150		P35.0109	1	PISTON		D11
[P35.1201]		P35.0106	1	MOTOR SUPPORT		A3
[P35.1202]		P35.1201	1	MOTOR SUPPORT		A3
[P35.1205]		P35.0109	1	BODY		B2
P35.1207			1	INSERT		B26
P35.1208			1	BASE PLATE		B26
[P35.1209]			1	GEARING CENTRAL PART		C3
P35.1210		P35.1209	1	GEARING CENTRAL PART		C3
P35.1211		P35.0109	1	SEALING PLUG		A8
[P35.1212]			1	PIVOT PIN		B2
P35.1214			1	STRIPPER		D4
P35.1215		P35.0109	1	FORK		A8
P35.1216			1	FORK BOLT		B4
P35.1216		P35.0109	1	FORK BOLT		A8
P35.1217	*		1	SLIDE JAW		B26
P35.1218			2	COLLAR SCREW		C26
[P35.1219]		P35.0106	1	MOTOR HOUSING		A4
[P35.1221]			1	INTERMEDIATE WHEEL		D2
P35.1222		P35.1221	1	INTERMEDIATE WHEEL		D2
P35.1223			1	INTERMEDIATE WHEEL SHAFT		C2
P35.1224			1	PINION		B2
P35.1225			1	INTERMEDIATE WHEEL		B2
P35.1226			2	RING		C1+
P35.1228	*		1	TENSIONING WHEEL		D1
P35.1232			1	STRAP STOP		D4
P35.1240			1	STRAP STOP		C2
P35.1248			1	STRAP STOP		D27
P35.1253		P35.0107	1	JACKET		B4
P35.1254		P35.0107	1	END PLATE		B5
[P35.1255]			1	GEARING COVER		C4
P35.1256		P35.1255	1	GEARING COVER		C3
P35.1257			1	COVER		A1
P35.1301		P35.0102	1	VALVE STEM		C20
P35.1302		P35.0102	1	VALVE STEM		C20
P35.1303		P35.0102	1	END RING		C20
P35.1304		P35.0102	1	VALVE LEVER		C23
P35.1305		P35.0102	1	SUSTAINING RING		C21
P35.1306		P35.0102	3	SUSTAINING RING		C21+
P35.1307		P35.0102	1	RING		C19
P35.1308		P35.0102	1	CYLINDER		C19
P35.1309		P35.0102	1	INTERMEDIATE RING		D20
P35.1310		P35.0102	3	SUSTAINING RING		D20+
P35.1311		P35.0102	1	SUSTAINING RING		D21
P35.1312		P35.0102	1	RING		D21
[P35.1313]		P35.0103	1	HANDLE		B34
P35.1315		P35.0102	1	THROTTLE HOLDER		C19
P35.1315		P35.0104	2	THROTTLE HOLDER		D17+
P35.1316		P35.0102	1	THROTTLE SCREW		C19
P35.1317		P35.0102	1	VALVE STEM		C21
P35.1318		P35.0102	1	VALVE STEM		C22
P35.1319		P35.0103	1	VALVE STEM		C35
P35.1320		P35.0103	1	STOP SLEEVE		A34
P35.1321		P35.0103	1	STOP SLEEVE		C35

* = Wearing Parts

[] = Group

49.4211.02	P350/16/0.80-1.10/3.8		P350.0003.02			23.02.00
Item-No.		in group	Pcs.	Description	Dimension	Field
P35.1322		P35.0103	1	END RING		D34
P35.1323		P35.0103	1	HOLDING BUSH		D35
P35.1324		P35.0103	1	HOLDING BUSH		A34
P35.1325			1	SEAL PLATE		D14
P35.1326			1	SEAL PLATE		D13
P35.1327		P35.0102	1	LEVER BODY		C24
P35.1329		P35.0102	1	VALVE LEVER		C24
P35.1330		P35.0103	1	VALVE LEVER		A33
P35.1331		P35.0103	1	VALVE LEVER		C33
P35.1332		P35.0103	2	LEVER BODY		A32+
P35.1333		P35.0102	1	LEVER SHAFT		D23
P35.1334			1	SEAL PLATE		B33
P35.1335			1	CONNECTION PIECE		C8
P35.1336		P35.0102	1	LEVER SHAFT		C24
P35.1336		P35.0103	2	LEVER SHAFT		A33+
P35.1337		P35.0102	1	SPRING GUIDE		C23
P35.1338		P35.0102	1	VARIABLE PISTON		B21
P35.1339		P35.0102	1	VALVE FACE RING		B21
P35.1340		P35.0102	1	EXHAUST RING		B22
P35.1343		P35.0102	1	ADJUSTING WHEEL		D24
P35.1344		P35.0102	1	SLIDE GATE		C22
P35.1345		P35.0102	1	VALVE SUPPORT		C22
P35.1346		P35.0102	1	INTERMEDIATE RING		C22
P35.1347		P35.0104	2	THROTTLE SCREW		C17+
P35.1348		P35.0104	2	THROTTLE BODY		C17+
P35.1349		P35.0104	2	THROTTLE SEAT		C16
P35.1350		P35.0102	1	COUNTER SLEEVE		B21
P35.1351		P35.0102	1	THROTTLE SLEEVE		B20
P35.1352		P35.0102	1	VALVE STEM		B20
P35.1353		P35.0102	1	END RING		B24
P35.1354		P35.0102	1	CYLINDER		B23
P35.1355		P35.0102	1	VALVE RING		B23
P35.1356		P35.0102	1	RING		B22
P35.1357		P35.0102	1	VALVE STEM		B23
P35.1358		P35.0102	1	RETAINER		B20
[P35.1401]			1	SUSPENSION		A37
[P35.1402]		P35.1401	1	SUSPENSION BRACKET		A38
P35.1405		P35.1401	1	FLANGE SHAFT		C39

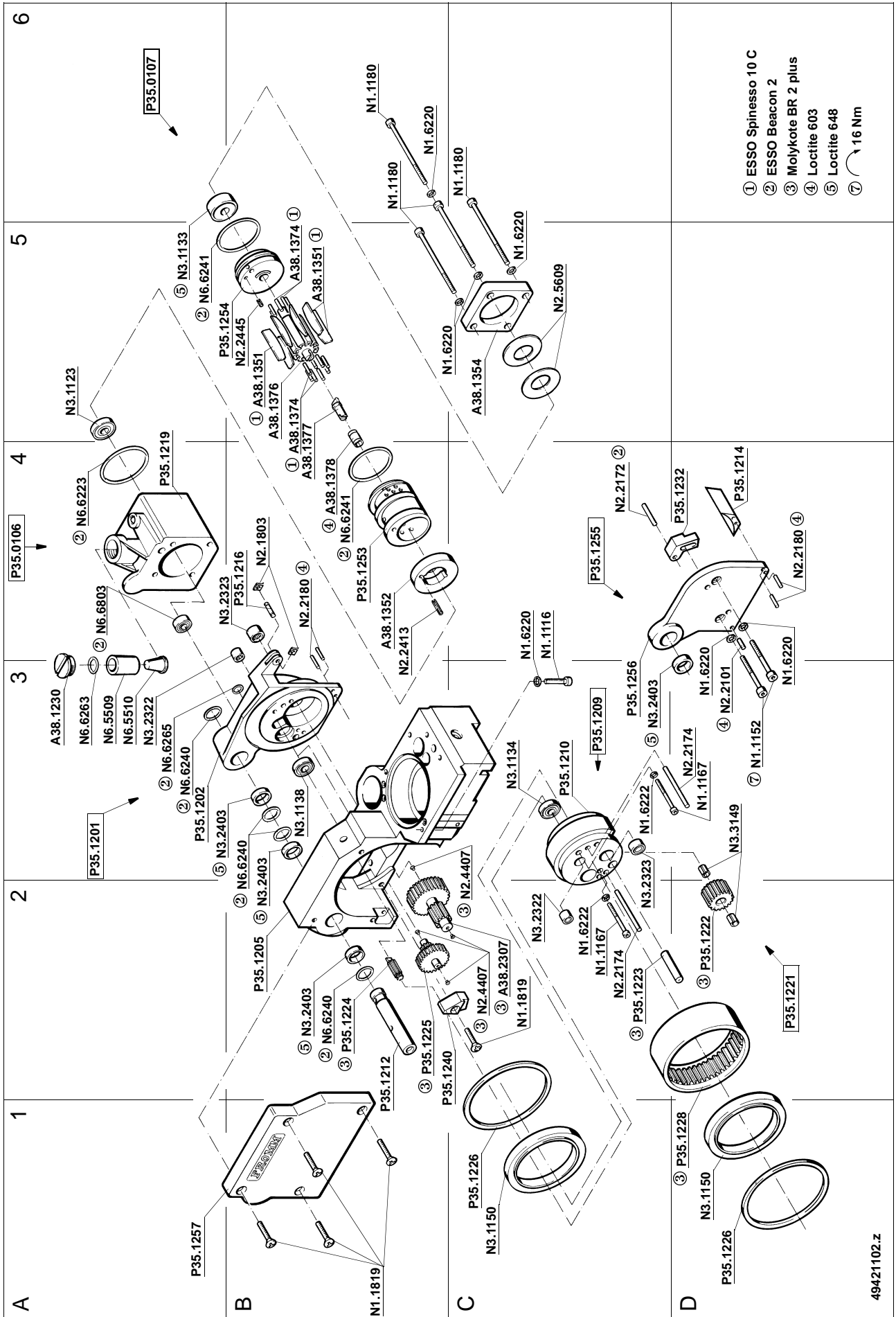

49421102.z

